

**RK**  
COMPRESSORS

# RK-ICM-10C Two Stage Pump



Équipements ESF inc.  
6500, Armand-Viau Street  
Quebec (Qc) Canada G2C 2J6  
T (418) 845-2318  
F (418) 845-5252  
[www.esfdirect.com](http://www.esfdirect.com)

# RK-ICM-10C Two Stage Pump

Torque	
Part	Foot-Pound Force (lb-ft)
Bolt, Flywheel	47-57
Bolt, Front and End Cover	14-16
Bolt, Side Cover	14-16
Bolt, Centrifugal Adapter Plate	9-12
Bolt, Oil Sight Cover	14-16
Bolt, Cylinder	19-27
Bolt, Connecting Rod	34-37
Bolt, Aftercooler	14-16
Bolt, Intercooler	14-16
Bolt, Cylinder Head	32-37
Bolt, Intake and Exhaust Valve Retainer	51-57
Bolt, Valve Cover	14-16
Bolt, Valve Seat	9-12

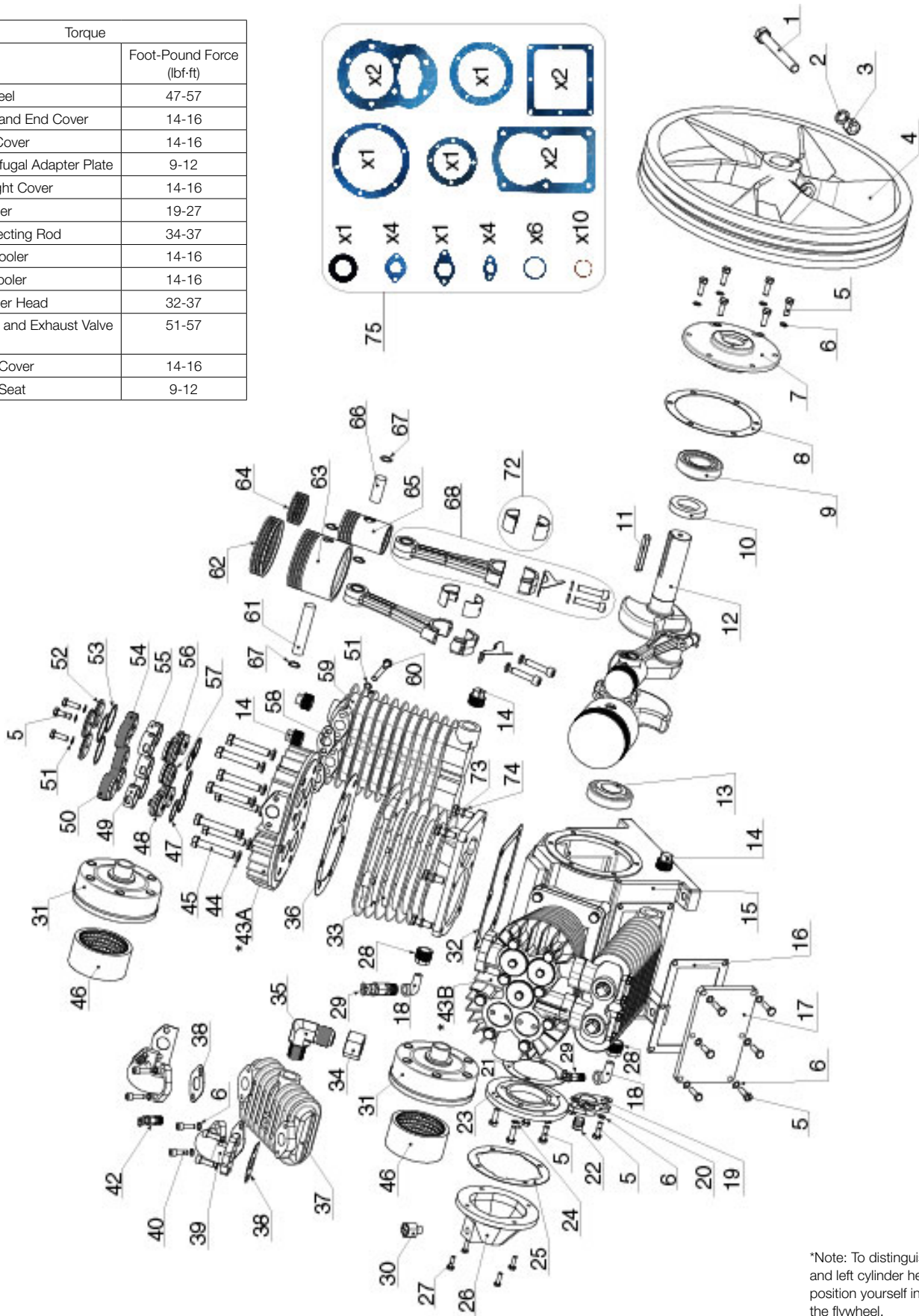

\*Note: To distinguish right and left cylinder heads, position yourself in front of the flywheel.

# RK-ICM-10C

## Two Stage Pump

### Part List

Item	Part Number	Description	Qty
1	RK-059-0163A	BOLT - FLYWHEEL (ICM-10C)	1
2	RK-060-0069	WASHER - FLYWHEEL	1
3	RK-058-0086	NUT - FLYWHEEL	1
4	RK-044-0051	FLYWHEEL	1
5	RK-059-0166	BOLT - FRONT COVER	30
6	RK-060-0061	COPPER WASHER	28
7	RK-045-0044	FRONT BEARING CARRIER	1
8	RK-046-0168	GASKET- FRONT CAP	1
9	RK-046-0179	SEAL- CRANKSHAFT	1
10	RK-051-0053	FRONT BEARING SET	1
11	RK-146-0015	KEY- FLYWHEEL	1
12	RK-053-0052	CRANKSHAFT ICM-10C	1
13	RK-051-0054	REAR BEARING CONE	1
14	RK-062-0006	PLUG - SIDE COVER	7
15	RK-049-0028	CRANKCASE ICM-10C	1
16	RK-046-0170	GASKET-SIDE COVER	2
17	RK-077-0072	SIDE COVER ICM-10C	2
18	RK-064-0022	ELBOW STREET	2
19	RK-046-0178	GASKET - SIGHT GLASS	1
20	RK-032-0031	FLANGED OIL SIGHT GLASS	1
21	RK-046-0227	GASKET- REAR COVER	1
22	RK-062-0004	OIL DRAIN PLUG	1
23	RK-077-0070	ADAPTER PLATE	1
24	RK-060-0070	WASHER - AFTERCOOLER ELBOW	4
25	RK-046-0171	GASKET - UNLOADER COVER	1
26	RK-077-0071	CENTRIFUGAL UNLOADER PLATE ICM-10	1
27	RK-059-0153	SOCKET HEAD BOLT 6X20- CENTRIFUGAL UNLOADER PLATE	4
28	RK-063-0006	BUSHING REDUCING	2
29	RK-136-0046	VALVE SAFETY - 75 PSI	2
30	RK-056-0018	CRANKCASE BREATHER	1
31	RK-019-0097	AIR FILTER ASSY.	2
32	RK-046-0167	GASKET-CYLINDER TO CRANKCASE	2
33	RK-050-0030	CYLINDER	2
34	RK-058-0085	NUT - DISCHARGE ELBOW ICM-10C	1
35	RK-083-0010	DISCHARGE ELBOW ICM-10C	1
36	RK-046-0166	GASKET- CYLINDER HEAD	2
37	RK-082-0013	AFTERCOOLER ICM-10C	1
38	RK-046-0172	GASKET-AFTERCOOLER	4
39	RK-083-0008	ELBOW-AFTERCOOLER ICM-10C	2
40	RK-059-0158	BOLT - AFTERCOOLER ELBOW	8
42	RK-136-0007	SAFETY VALVE - 200 PSI	1
43A	RK-042-0055	CYLINDER HEAD (RH)	1
43B	RK-042-0056	CYLINDER HEAD (LH)	1
44	RK-060-0105	WASHER - CYLINDER HEAD ICM-10C	16
45	RK-059-0167	BOLT - CYLINDER HEAD	16
46	RK-019-0023	AIR FILTER ELEMENT	2
47	RK-060-0062	COPPER GASKET- VALVE SEAT	10
48	RK-043-0098	INTAKE VALVE ASSEMBLY LOW PRESSURE	4
49	RK-043-0094	INTAKE VALVE SPACER	4
50	RK-058-0082	VALVE RETAINER-INTAKE	4
51	RK-060-0061A	COPPER WASHER B8	14
52	RK-077-0073	VALVE COVER	6
53	RK-046-0174	GASKET-VALVE COVER	6
54	RK-058-0083	VALVE RETAINER-DISCHARGE	6

Item	Part Number	Description	Qty
55	RK-043-0095	EXHAUST VALVE SPACER	6
56	RK-043-0099	INTAKE VALVE ASSEMBLY HIGH PRESSURE	2
57	RK-043-0100	EXHAUST VALVE ASSEMBLY HIGH AND LOW PRESSURE	4
58	RK-046-0173	GASKET-INTERCOOLER	4
59	RK-082-0012	INTERCOOLER	2
60	RK-059-0157	BOLT - INTERCOOLER	8
61	RK-052-0027	WRISTPIN-LP	2
62	RK-054-0179	RING SET LOW PRESSURE	2
63	RK-048-0054	PISTON-LP	2
64	RK-054-0178	RING SET HIGH PRESSURE	2
65	RK-048-0081	PISTON-HP	2
66	RK-052-0028	WRISTPIN-HP	2
67	RK-054-0119	INTERNAL SNAPRING	8
68	RK-047-0054	CONNECTING ROD, ALUMINUM	4
72	RK-051-0055	BEARING INSERT SET	4
73	RK-059-0159	BOLT - CYLINDER	12
74	RK-060-0063	COPPER WASHER - CYLINDER BOLT	12
75	RK-046-0185	GASKET SET ICM-10C Includes : Item 8 1 x RK-046-0168 GASKET- FRONT CAP Item 9 1 x RK-046-0179 SEAL- CRANKSHAFT Item 16 2 x RK-046-0170 GASKET-SIDE COVER ICM-10C Item 19 1 x RK-046-0178 GASKET - SIGHT GLASS Item 21 1 x RK-046-0227 GASKET- REAR COVER Item 25 1 x RK-046-0171 GASKET - UNLOADER COVER Item 32 2 x RK-046-0167 GASKET-CYLINDER TO CRANKCASE Item 36 2 x RK-046-0166 GASKET- CYLINDER HEAD Item 38 4 x RK-046-0172 GASKET-AFTERCOOLER Item 47 10 x RK-060-0062 COPPER GASKET- VALVE SEAT Item 53 6 x RK-046-0174 GASKET-VALVE COVER Item 58 4 x RK-046-0173 GASKET-INTERCOOLER	1

### WARNING

This pump has a special "break-in" oil, which must be changed after the first 10 hours of operation. Replacement oil should be SAE 30 non detergent.